

AMIX 4



A *breathtaking*
innovation

AIRMASTER

AMX4

Ventilation. Heating. Cooling. All in one.

Introducing our revolutionary innovation, the AMX - the perfect all-in-one solution that combines reliable indoor ventilation with comfortable indoor temperature. The AMX integrates ventilation and heat recovery and incorporates a reversible air-to-air heat pump for optimal indoor climate control. AMX provides great ventilation, heating and cooling in just one system.

Take charge of your indoor climate

AMX is designed for a quick and easy installation and requires minimal maintenance, making it a hassle-free and cost-effective solution for your needs. With its intuitive and user-friendly interface, control is effortless. Moreover, it can be seamlessly connected to Airmaster cloud solution Airlinq® Online, allowing you to take charge of your indoor climate from your mobile or tablet device.

Ventilation
Heating
Cooling
all in one

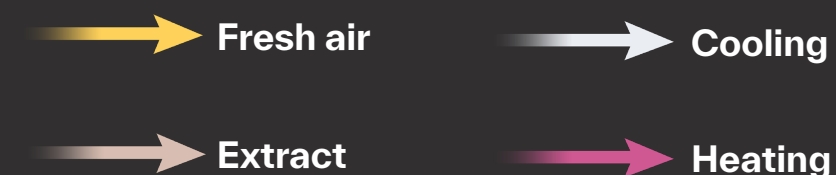
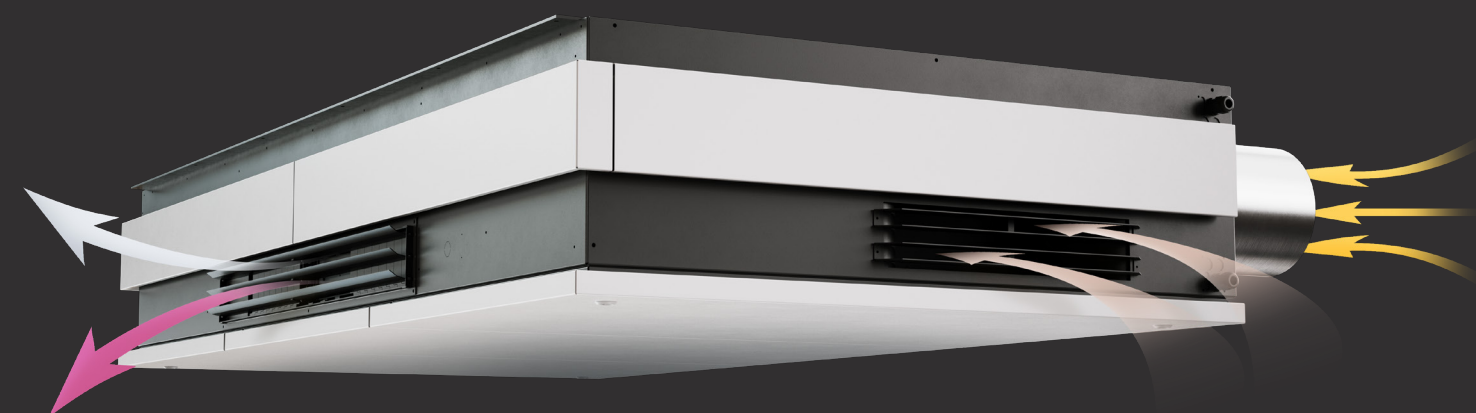

Boost indoor climate. Reduce energy bill

AMX ensures optimal atmospheric and thermal comfort while reducing energy consumption and utility costs by efficiently conditioning incoming air. Its intelligent control logic regulates cold or warm air, optimizing both ventilation and energy usage. Additionally, the use of natural refrigerant R290 in the heat pump significantly minimizes environmental impact.

Comforting indoor silence

AMX is designed with a low sound level to be placed indoors with no distracting compressor noise. Moreover, the versatile design allows for seamless integration into most building types, including low buildings with the option of ceiling mounting.



AMX 4

Ventilation system with reversible heat pump.

The compressor is built into the unit - No external or outside components. The compressor is sound, and vibration dampened via Airmaster's patented suspension system.

Plug n' play ventilation, heating and cooling solution. Only requires power, drain and network (optional).

Environmentally friendly refrigerant (R290) with a Global Warming Potential of only 0.02.

Take full control of your indoor climate. The AMX system handles ventilation, heating, and cooling, and with Airmaster's Thermal Airflow supply system, it ensures a comfortable environment without drafts or temperature stratification.

Control your AMX system using either a control panel or our cloud-based solution, Airlinq® Online, which provides full functionality to precisely manage the indoor climate according to the specific needs of the room.

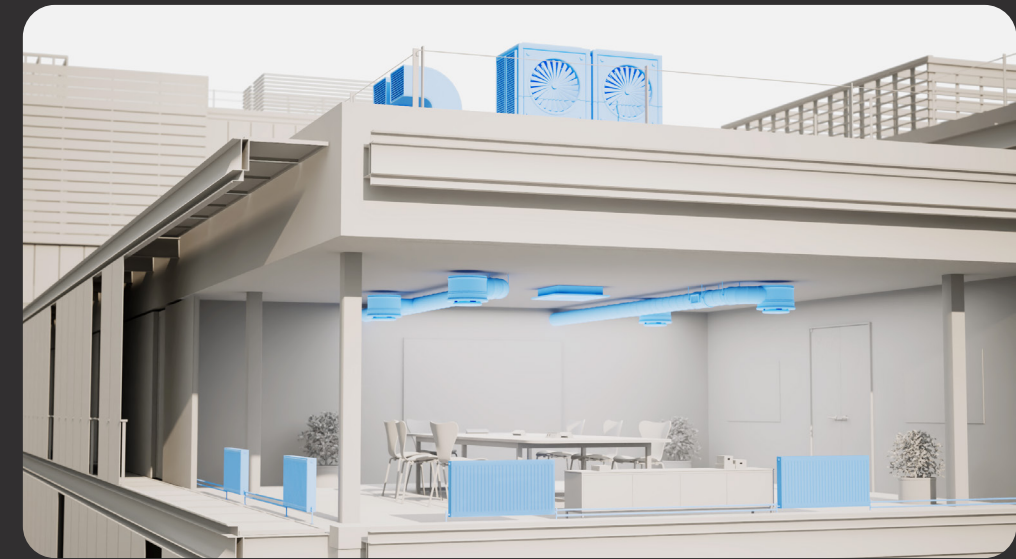

Leaving behind the old system providers

To supply a room with ventilation, heating and cooling you traditionally need three different system providers. A ventilation unit, which can be central or decentral, a heating supply such as a radiator, a cooling unit such as a split cooler with a chiller on the roof. Together these three supply units can be very complex to control and costly to install and increase the energy cost while running three different systems. Above is displayed a typical room with individually supply of ventilation, heating, and cooling.



Ready for one indoor climate solution

The quiet AMX replaces above three system providers and you have only one indoor climate solution with ventilation, heating, and cooling. This reduces installation cost because you only have one installation, and at the same time your operating cost will be reduced because of the intelligent built in control system, this ensures that AMX only uses energy when needed.

The AMX takes up less space in the room, only two holes in the wall, no outside parts and no ducts - a unique plug and play solution for an optimal indoor climate.

AMX 4

Unique controlling

AMX is designed to run automatically for an optimal indoor climate with ventilation, heating, and cooling in one. The AMX optimizes both supply air temperature and airflow to maintain the desired room temperature, while also adjusting ventilation based on CO₂ levels for maximum energy efficiency and comfort.

Here is a short overview which displays different operating modes of AMX. These modes will be controlled automatically, by the unique AMX controlling system, depending on the needs for ventilation, heating, cooling or recirculating for an optimal indoor climate.

Ventilation Bypass with cooling

The room temperature is warm, and the outside temperature is temperate. AMX cools down and ventilates the room with fresh air bypassing the heat exchanger.

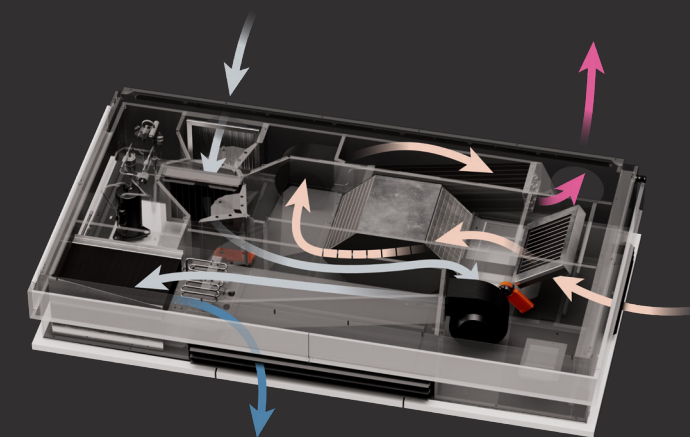

Ventilation, heating and cooling

The outside temperature is cold or warm, and the room temperature is temperate. AMX warms or cools and ventilates with fresh air.

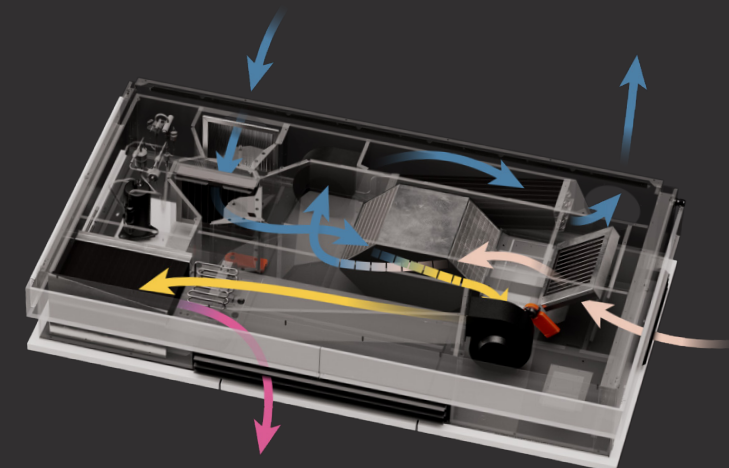

Recirculating heating and cooling

Room temperature is cold or warm and outside temperature is temperate. AMX cools or heat up the room – no fresh air is needed.

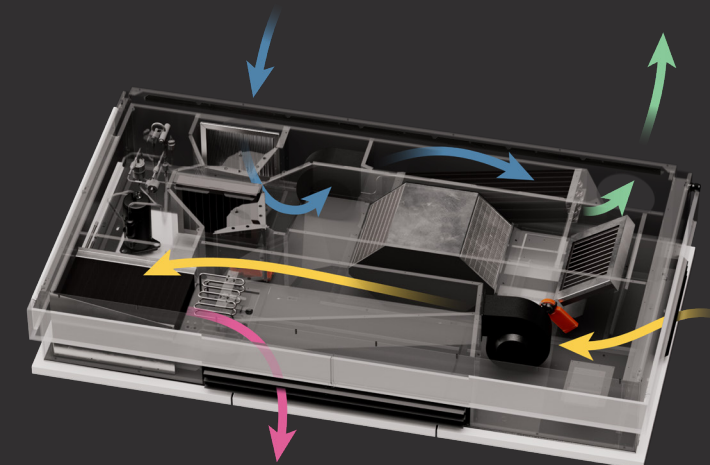

Unique control features



Using separate summer and winter schedules the AMX 4 unit can be individually adjusted for each room to ensure an optimal indoor climate throughout the entire year.



The night cooling strategy ensures comfortable indoor conditions during the day by pre-cooling the building during the night.

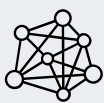

The system's draft and stratification control algorithm ensures a comfortable indoor experience by preventing both drafts and uneven temperature distribution within the room.



The unique defrosting process for the heat pump surfaces ensures optimal performance while minimizing energy consumption.



Cooling recovery captures and reuses excess heat from the cooling process, improving energy efficiency and reducing consumption when conditions allow.

Technical Data

Technical data	Filter class	30 dB(A)	35 dB(A)
Maximum capacity	ePM ₁₀ 50%	256 m³/h	334m³/h
	ePM ₁ 55%	251 m³/h	330m³/h
	ePM ₁ 80%	231 m³/h	316m³/h
Heating and cooling			
Heating capacity ventilation, 7 °C (outside temperature)		4000 W	
Heating capacity recirculation, 7 °C (outside temperature)		3000 W	
Cooling capacity ventilation, 35 °C (outside temperature)		1800 W	
Cooling capacity recirculation, 35 °C (outside temperature)		1230 W	
Heat output recirculation, -15 °C (outside temperature)		2300 W	
COP (heating) recirculation		3,7	
EER (cooling) recirculation		3,0	
SCOP		Recirculation = 2,8 / Ventilation = 7,8	
SEER		Recirculation = 3,2 / Ventilation = 2,4	
Refrigerant / Global Warming Potential (GWP)		R290 / 0,02	
Filling		330 g	

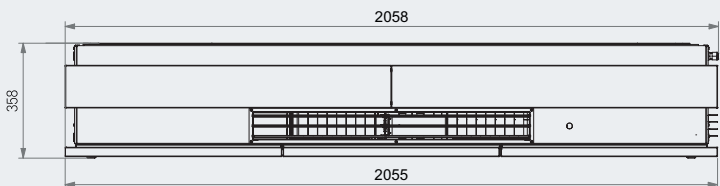
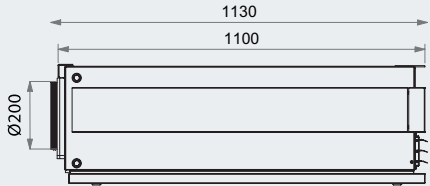



AIRMASTER

(+45) 9862 4822

Info@airmaster.dk