

## Quick Guide AIRLINQ® Orbit

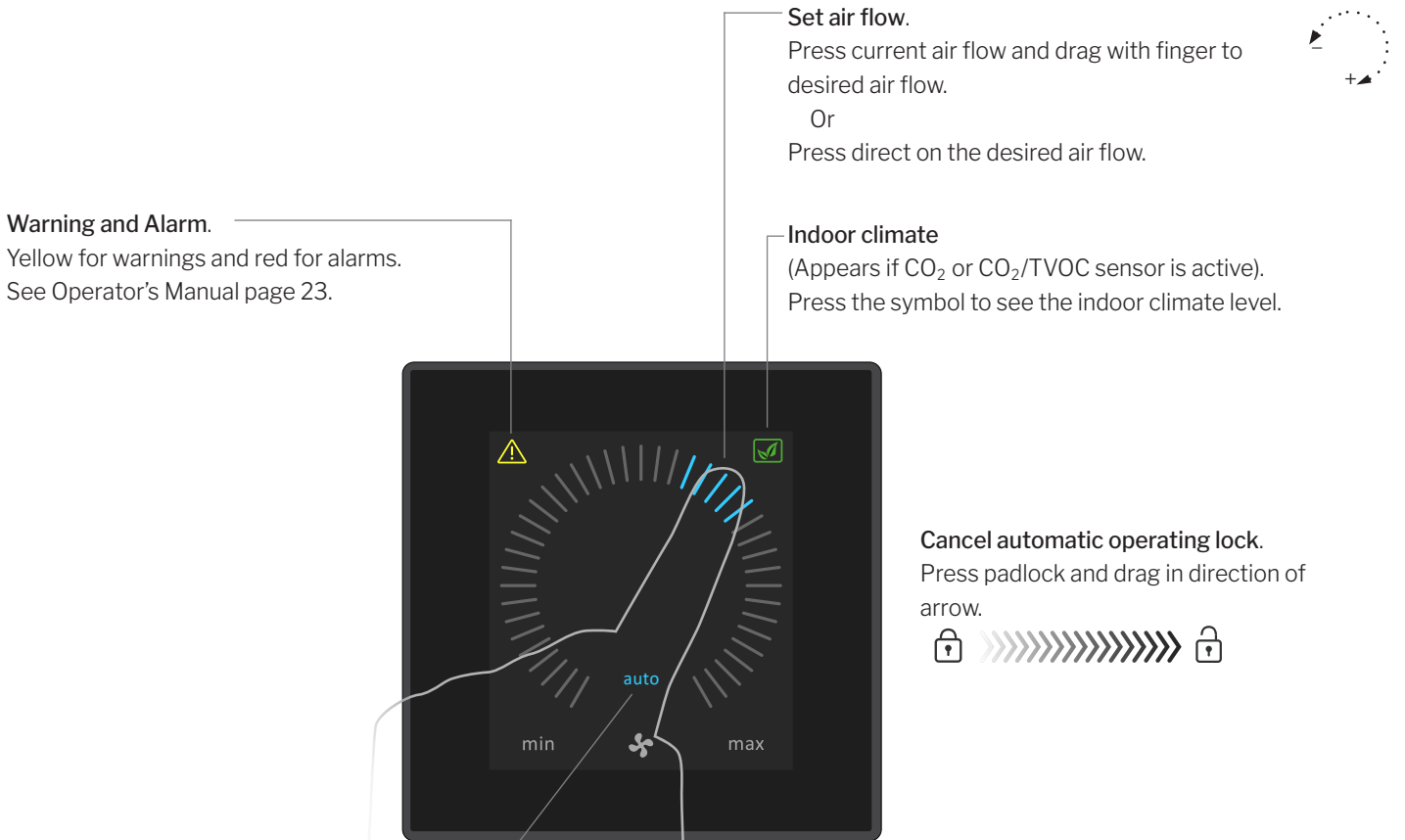

**Warning and Alarm.**  
Yellow for warnings and red for alarms.  
See Operator's Manual page 23.

**Set air flow.**  
Press current air flow and drag with finger to desired air flow.  
Or  
Press direct on the desired air flow.



**Indoor climate**  
(Appears if CO<sub>2</sub> or CO<sub>2</sub>/TVOC sensor is active).  
Press the symbol to see the indoor climate level.

**Cancel automatic operating lock.**  
Press padlock and drag in direction of arrow.



**"auto".**  
Shows when unit is in automatic operation.

**Mini-B USB port.**  
See Operator's Manual page 11.

**Function button:**

**Start control menu.**

Press.

- Start or restart automatic operation.  
Press "⏻ AUTO".

- Start operation manual.  
Press "⏻ START".

- Standby.  
Press "zzz STANDBY".

- Switch Off.  
Press "⏻ OFF". Afterwards the unit has to be started manually.

- Activate Holiday mode.  
Press "🏠 HOLIDAY MODE".

- Setup.  
Press "⚙️ SETUP". (See Operator's Manual page 16 to 19.)

- Status menus.  
Press "📊 STATUS".

- Cancel Screen lock.  
See Operator's Manual page 19.

**Switch off.**

Press for min. 2 seconds. Afterwards the unit has to be started manually.

